

Check before installation

01. Components

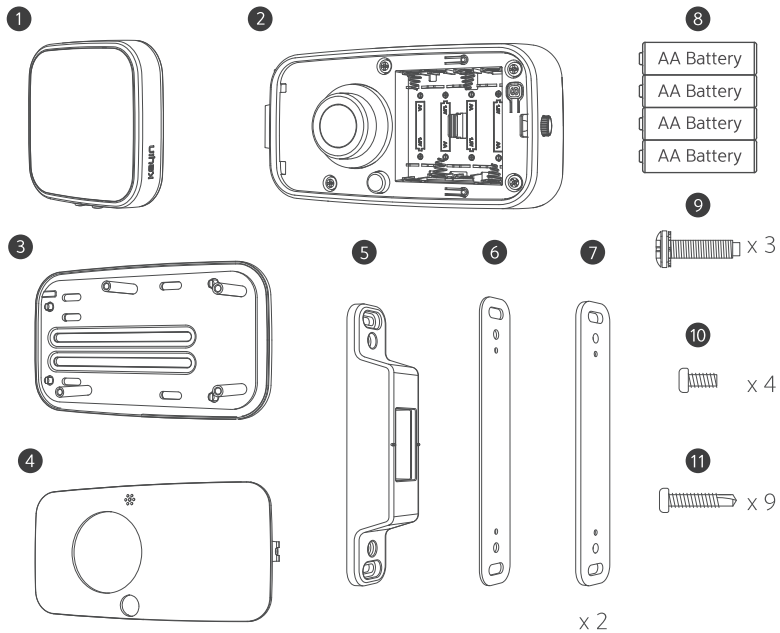

1	Front body	7	Strike extender 1,5mm
2	Main body	8	AA Battery
3	Main bracket	9	Guide screw
4	Battery cover	10	Main body screw
5	Strike	11	Main bracket/Strike screw
6	Strike extender 1,5mm		

02. Door type

* Depending on door opening direction (Outside view)

* Depending on the main hand use when opening

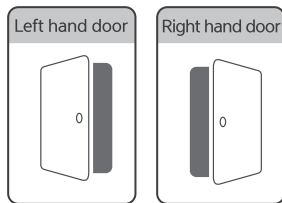
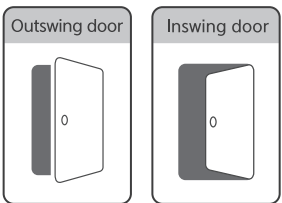

(View from outside)

Installation method differs depending on the type of door. This installation manual is based on outswing doors, Left/right hand door both applicable. To install on inswing door, check the video on the QR code in the right side.

Installation (Outswing/Right hand door based)

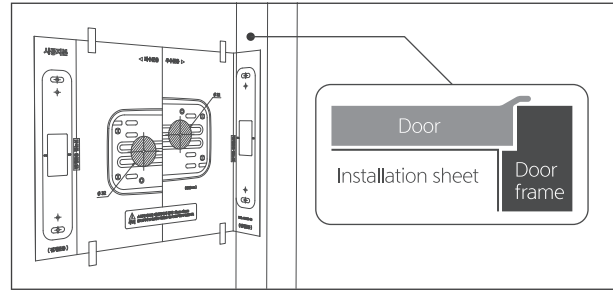

01. Close the door, attach the installation sheet to the doorframe, and label the location of punch hole and screw. Then punch a hole of 32mm diameter.

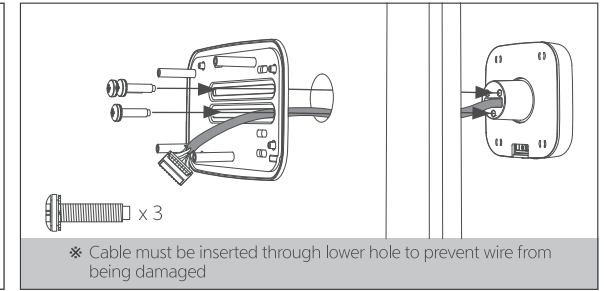

02. Pass the front body wire through the 32mm hole and main bracket lower hole, then attach the main bracket and front body with 3 guide screws.

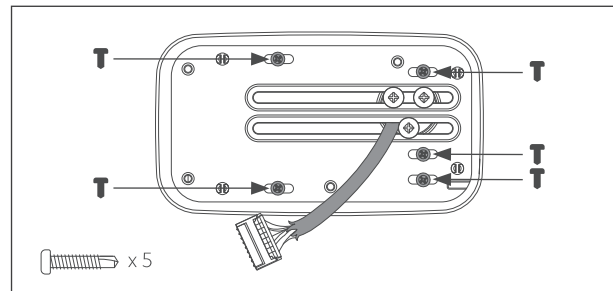

03. Using the main bracket screw, firmly attach the main bracket to the door.

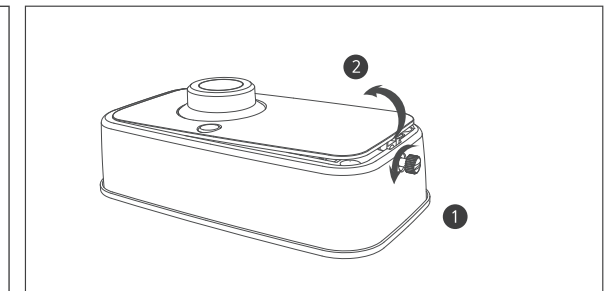

04. Dislocate the battery cover by unscrewing the cover screw counterclockwise.

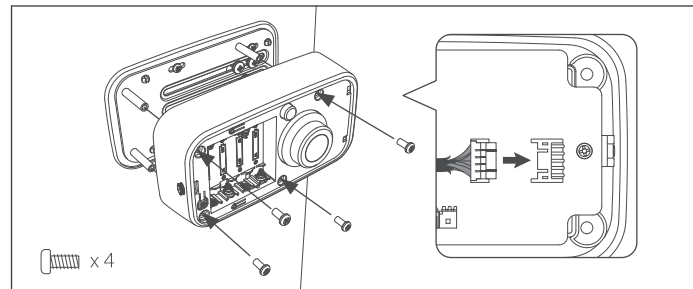

05. Connect the wire connector to the main body and then attach it to the bracket

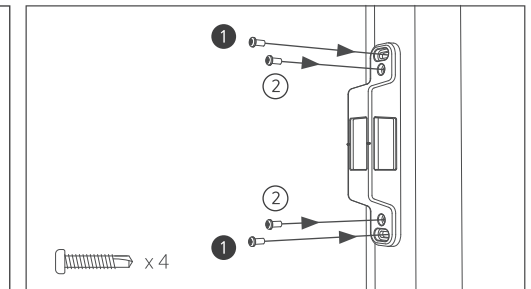

06. Slightly punch in screw #1, check the distance between the latch and main body, and firmly fasten the screw.

07. Check the door, insert the batteries, and finally check the door lock by pressing the open/dose button.

Checklist after installation

1. Close and open the door multiple times to check any problems in installation.
2. Register password and card key and check if the door lock opens accordingly
3. Check if auto locking works properly

Installation Video

Scan this QR code for step by step installation video



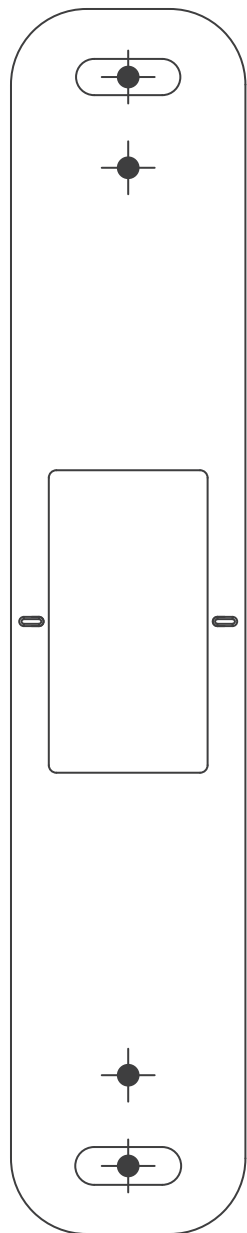

Installation Sheet

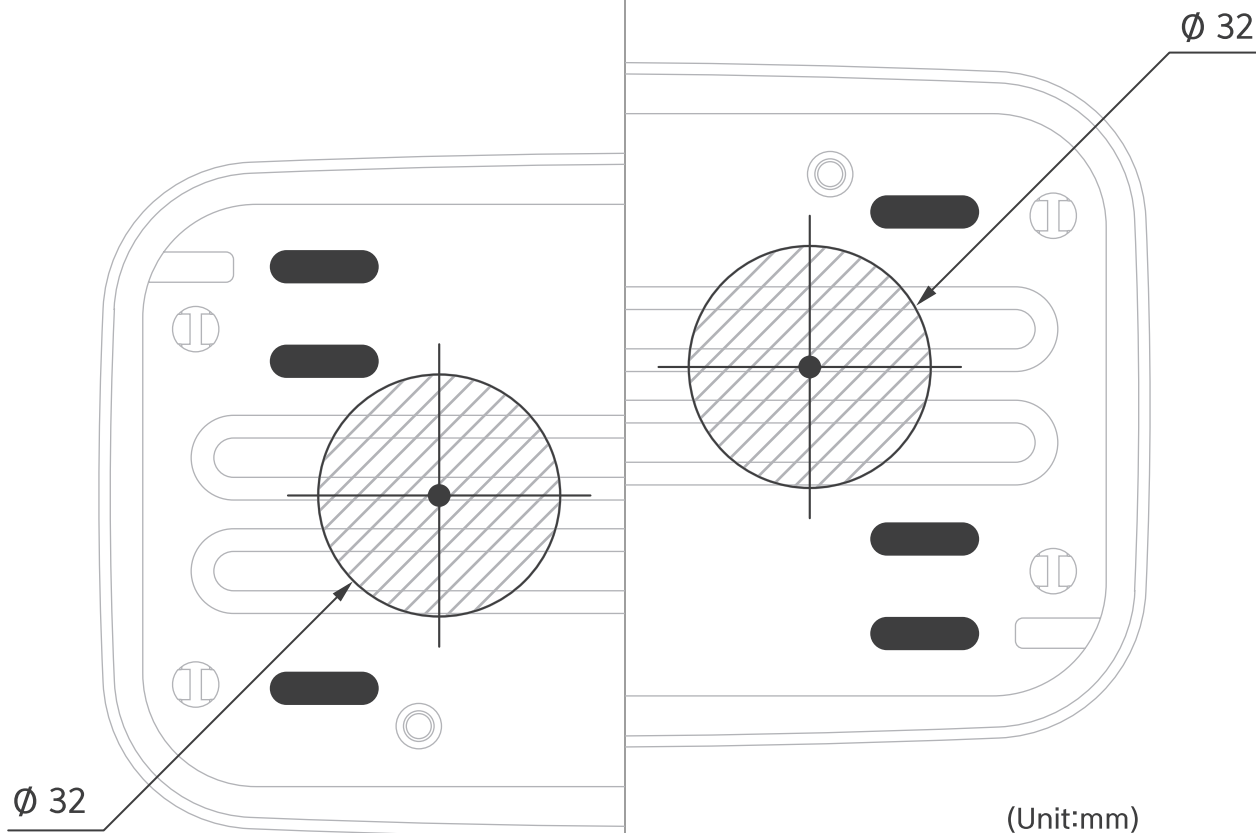

◀ Left hand door

Right hand door ▶



CAUTION  **Gap between Strike and Main body : 5mm±1mm**
Auto locking might not work properly if gap exceeds standards.

Folding Line

